

L. Roberto Lomas P.E.

1432 Woodford Rd
 Lewisville, NC 27023
 434-688-0609

rlomas@lrlomaspe.com

Client: stergis
 Report #: 514372-1

Date: 01/10/2019

Maximum design pressure per comparison Series 143.191AW

Procedure:

Tributary areas are identified and calculated for tested unit. These areas are used to determine the maximum uniform load distribution (ULD) and concentrated load. The maximum ULD and the concentrated load are used to determine the maximum load and maximum design pressure rating of sample unit. These calculations are performed in accordance with Rule 61G20-3, AAMA103, AAMA2502. These calculations comply with requirements of the Florida Building Code.

Test report No.: ESP014395P-3

Standards used for testing: AAMA/WDMA/CSA 101/I.S.2/A440

Tested Unit:

ULD Calculations

Unit width: 53.1 in
 Unit height: 39.0 in
 Design pressure: + 70.0 psf
 - 70.0 psf
 Water test pressure: + 12.0 psf
 Maximum cyclic pressure: N/A psf

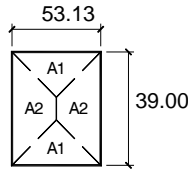

Concentrated load calculations

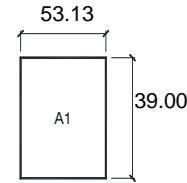

Tributary area: $A_1 = 14.4 \text{ ft}^2$

| | Zone | Area (ft ²) | Load (lbs) | ULD (lbs/in) |
|----------|----------------|-------------------------|------------|--------------|
| Positive | A ₁ | 4.55 | 319 | 6.00 |
| | A ₂ | 2.64 | 185 | 4.74 |
| Negative | A ₁ | 4.55 | 319 | 6.00 |
| | A ₂ | 2.64 | 185 | 4.74 |

Design pressure limitations:
 + 80.0 psf
 - 105.0 psf

Concentrated load formulas:

$$A_1 D_1 = A_2 D_2 \quad D_2 = \frac{A_1 D_1}{A_2}$$

Sample Unit:

ULD Calculations

Unit width: 25.0 in
 Unit height: 64.0 in

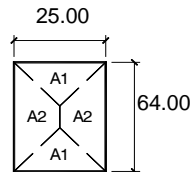

| | Zone | Area (ft ²) | ULD (lbs/in) | Max. Dp (psf) | Load (lbs) |
|----------|----------------|-------------------------|--------------|---------------|------------|
| Positive | A ₁ | 1.09 | 6.00 | 138.2 | 150 |
| | A ₂ | 4.47 | 6.00 | 85.9 | 384 |
| Negative | A ₁ | 1.09 | 6.00 | 138.2 | 150 |
| | A ₂ | 4.47 | 6.00 | 85.9 | 384 |

Concentrated load calculations

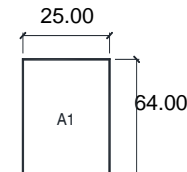

Tributary area: $A_2 = 11.1 \text{ ft}^2$
 Positive rating per concentrated: $D_p = 90.6 \text{ psf}$
 Negative rating per concentrated: $D_p = 90.6 \text{ psf}$

Sample unit rating:
 + 80.0 psf
 - 85.9 psf

Check Glazing:

| Glass Type | Width (in) | Height (in) | Area (ft ²) | Load Resistance per ASTM E1300-02/03/04/09 (psf) |
|-------------------------------------|------------|-------------|-------------------------|--|
| 3/4" IGU: 1/8" Ann - air - 1/8" Ann | 20.06 | 59.06 | 8.23 | 63.6 |

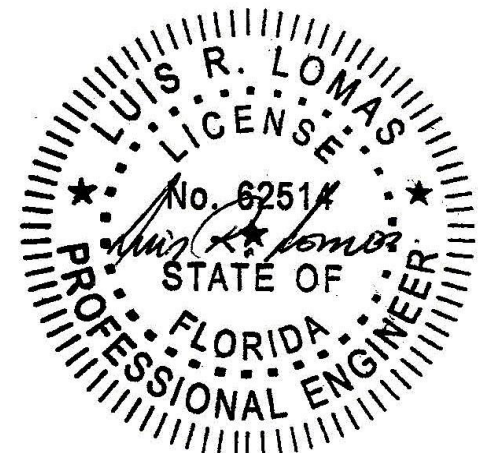

Luis R. Lomas P.E.
 FL No. 62514
 2/2/2019